

A024

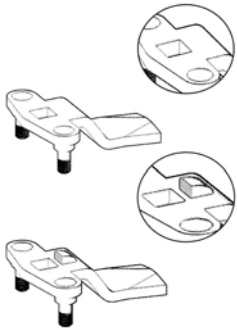

Material

Steel, zinc plated.

Technical Notes

Dimension "h" is the distance by which the cam is off-set.

Available with and without "projection".

Projection ensures correct location of cam, and prevents turning over 45°.

Tips

Suitable for all Flexi-System quarter turn fasteners, for specific suitability see technical notes of specific quarter turn fastener. For suitable rods and guides for 3 point latching systems see part A030 page 56 and A032 page 57. For other cams see A020 to A028 page 52.

Important Notes

For correct cam selection use following formula:

$$h = D_f - Q_L$$

where;

h = required Cam off-set.

D_f = depth of cabinet or enclosure frame.

Q_L = body length of quarter turn fastener to be used.

Flexi System - cut out

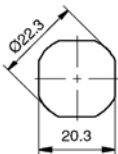

Two Point Cams, Flexi-System

for quarter turn fasteners

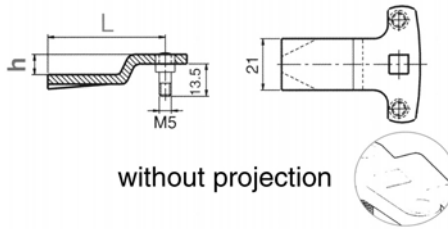

without projection

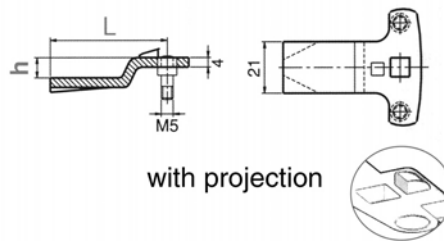

with projection

Order No. with projection	Order No. w/o projection	h	L
A024.AC407	A024.AC427	7	49
A024.AC412	A024.AC432	12	46
A024.AC500	A024.AC520	0	51