

A030



Material

Rod: 8mm dia. zinc plated steel.
Rollers: polyamide, Pa6 GFR 30.

Technical Notes

For use with our quarter turn fasteners, making a fully comprehensive latching system.
Height between base of rod and inside of door when using rod guides is 24 mm.

Tips

Rods can be cut to length to suit your application. Rod adaptor fits to any length of rod.

Important Notes

Rod guides mounted either via an M6 x 16 counter sunk screw or M6 x 16 weld on stud.

Round Rod, Latching System Set

for quarter turn fasteners

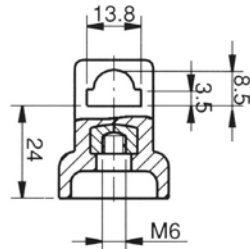
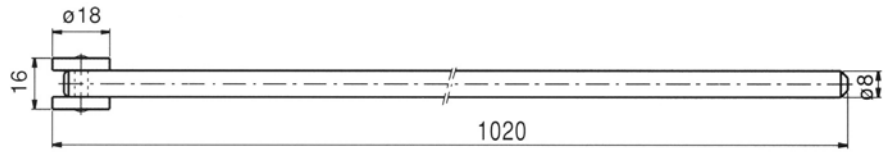

Mounting Options

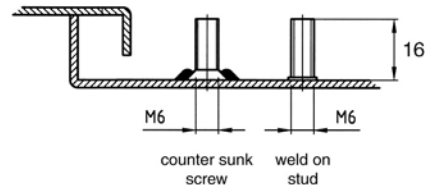

Order No.

A030.AC010

Set Contents

2 pcs. round rod with roller, 1020 mm
2 pcs. rod adaptors
2 pcs. rod guides



Rod adaptor



Rod guide

Wixroyd Stainless Steel Elements

STAINLESS STEEL:

Within Wixroyd's wide range of products there are many stainless steel products ideal for the medical, pharmaceutical and food & drink processing industries in both A303 and A316 grade stainless steel. Stainless items are usually available ex-stock for same day despatch. Look for the stainless steel symbol in our pictorial index.



CAD library in 3D and 2D formats:

- 3D: Step (step), Acis (sat), Parasolid v14.0 (x_t), Catia (3d igs), ProEngineer (prt), SolidWorks 2003 (sldprt)
- Integral Menu Systems: SolidWorks 2003, Inventor 5 to Inventor 7, AutoCAD 14/MDT3 to AutoCAD 2002/MDT6.
- 2D: IGES (iges), DXF (dxf), and AutoCAD 14 to 2002