

E100



Material

Body and Push Knob: all ABS Plastic.

Technical Notes

Suitable for door/wall thicknesses 15 to 35mm.

When installed the push knob is near flush with surface, raised only 4mm from surface.

Supplied with screws (M3 x 20).

Tips

For surfaces between 15 to 25mm thick no counter bore is required.
For surfaces from 26 to 35mm thick, 40 mm dia counter bore of depth "H" is required.

H = door thickness - 25mm.

Push Knobs

plastic

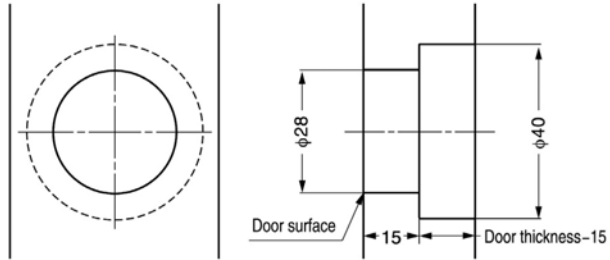
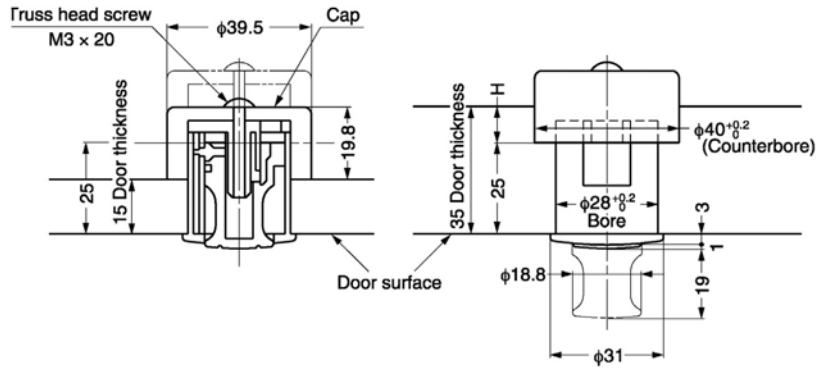

Order No.	Finish	g
E100.AC010	White	46
E100.AC020	Black	46