

## Draw Latches

stainless steel

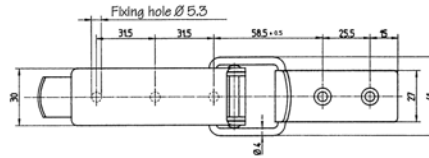

# J040

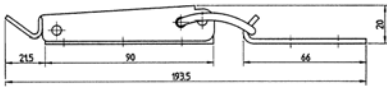

**Technical Notes**  
Supplied with counter strike.

Order No.	Finish	L	W	H	Max. Load N	Max. Tension N	g
J040.AC004	Zinc plated Steel	193,5	41	20	2000	4000	190
J040.AC030	Stainless Steel	193,5	41	20	2000	4000	190

## Draw Latches

with padlock shackle, stainless steel

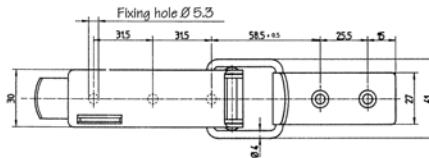
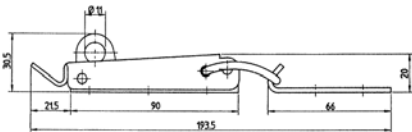

# J042



**Technical Notes**  
Supplied with counter strike.

Order No.	Finish	L	W	H	Max Load N	Max Tension N	g Approx.
J042.AC004	Zinc plated Steel	193,5	41	20/30	2000	4000	190
J042.AC030	Stainless Steel	193,5	41	20/30	2000	4000	190

## Draw Latches

stainless steel

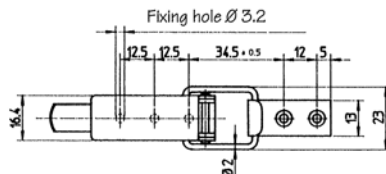
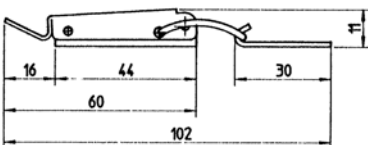

# J044



**Technical Notes**  
Supplied with counter strike.

Order No.	Finish	L	W	H	Max Load N	Max Tension N	g
J044.AC004	Zinc plated steel	102	23	11	550	1500	30
J044.AC030	Stainless steel	102	23	11	550	1500	30