

Torque Dampers

unidirectional, torque adjustable

Wixroyd

Q020



Material
PBT plastic, black.

Technical Notes
110° operating angle, additional 4° dead angle at start/end position.
Tested to over 100,000 cycles.
Temperature range 0° to 40°C.

Tips
Dampers provide smooth and quiet motion of lids, covers etc. Ideal for applications in vending machines, special purpose machines, printers, air conditioning units and furniture.

Important Notes
Torque calculation:
 $T \text{ (Kgf/cm)} = W \text{ (Kg)} \times 0.5 \times H \text{ (cm)}$.
W (Kg) is weight of cover/lid, H (cm) is distance between fulcrum and cover/lid's opening edge.

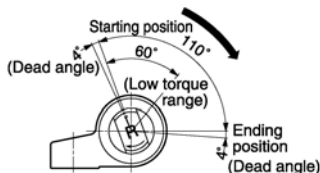
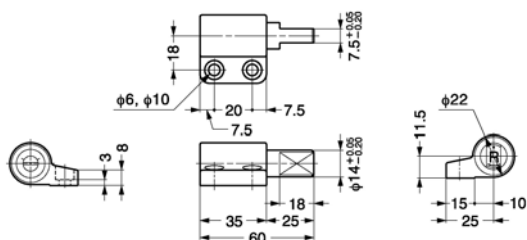

Q020.AC010 & AC020 shown
AC110 & AC120 symmetrical to vertical.

Order No.	Type	Operating Angle	Torque Kgf/cm
Q020.AC010	Right	110°	5 - 13
Q020.AC020	Right	110°	10 - 20
Q020.AC110	Left	110°	5 - 13
Q020.AC120	Left	110°	10 - 20

Torque Dampers

unidirectional, torque adjustable

Wixroyd

Q025



Material
PBT plastic, black.

Technical Notes
110° operating angle, additional 4° dead angle at start/end position.
Tested to over 100,000 cycles.
Temperature range 0° to 40°C.

Tips
Provide smooth and quiet motion of lids, covers etc. Ideal for special purpose machines, air conditioning units etc.

Important Notes
Torque calculation:
 $T \text{ (Kgf/cm)} = W \text{ (Kg)} \times 0.5 \times H \text{ (cm)}$.
W (Kg) is weight of cover/lid, H (cm) is distance between fulcrum and cover/lid's opening edge.

Referral
For torque damper brackets see part Q030 page 204 or for complete torque damper hinges see Q100 page 206.

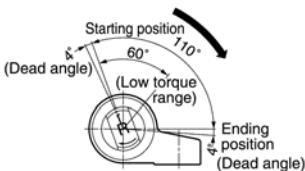
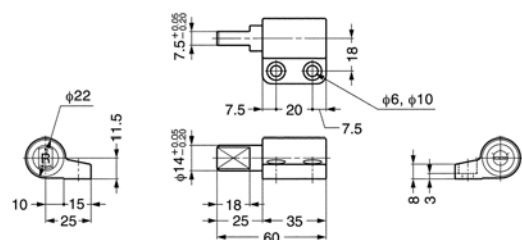

Q025.AC010 & AC020 shown,
AC110 & AC120 symmetrical to vertical.

Order No.	Type	Operating Angle	Torque Kgf/cm
Q025.AC010	Right	110°	5 - 13
Q025.AC020	Right	110°	10 - 20
Q025.AC110	Left	110°	5 - 13
Q025.AC120	Left	110°	10 - 20