

# Palm Grips

with grub screw



## U012



### Material

Duroplast PF 31 to DIN 7708, black.  
Grub screw: steel, galvanised.

### Technical Notes

Special designs e.g. different lengths or grub screws in brass, or stainless steel can be made to order depending on quantity.  
Temperature range 110°C.

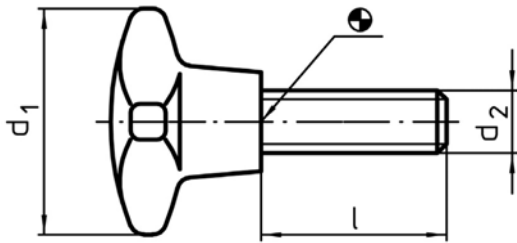

grip dimensions according to no. U010

Order No.	d <sub>1</sub>	d <sub>2</sub>	l	 g
U012.AC051	25	M 5	10	5,0
U012.AC052	25	M 5	15	5,5
U012.AC053	25	M 5	20	6,0
U012.AC054	25	M 5	25	6,5
U012.AC055	25	M 5	30	7,0
U012.AC061	32	M 6	15	13,5
U012.AC062	32	M 6	20	14,0
U012.AC063	32	M 6	25	15,0
U012.AC064	32	M 6	30	16,0
U012.AC065	32	M 6	40	17,0
U012.AC081	40	M 8	20	23,0
U012.AC082	40	M 8	25	26,0
U012.AC083	40	M 8	30	28,0
U012.AC084	40	M 8	40	30,0
U012.AC085	40	M 8	50	33,0
U012.AC101	50	M10	25	41,0
U012.AC102	50	M10	30	44,0
U012.AC103	50	M10	40	48,0
U012.AC104	50	M10	50	52,0
U012.AC105	50	M10	60	57,0
U012.AC121	63	M12	30	80,0
U012.AC122	63	M12	40	85,0
U012.AC123	63	M12	50	93,0
U012.AC124	63	M12	60	161,0
U012.AC125	63	M12	80	112,0
U012.AC161	80	M16	40	165,0
U012.AC162	80	M16	50	175,0
U012.AC163	80	M16	60	190,0
U012.AC164	80	M16	80	210,0