

W002



Material
Thermoplastic, black.

Technical Notes
For use with both fixed feet and levelling feet.

Threaded Plastic Inserts for Hollow Section

no bush

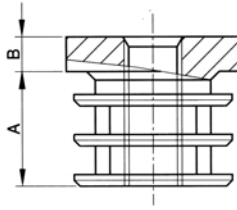

Square

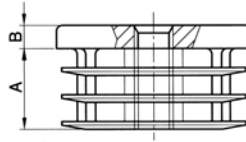

Rectangular

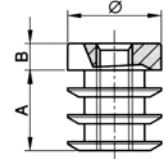

Round

| Order No. | Type | Tube Size (mm) | Thread Size | A | B |
|------------|-------------|----------------|-------------|----|---|
| W002.AC015 | Square | 15 x 15 | M 8 | 18 | 5 |
| W002.AC016 | Square | 16 x 16 | M 8 | 18 | 5 |
| W002.AC018 | Square | 18 x 18 | M10 | 18 | 5 |
| W002.AC020 | Square | 20 x 20 | M10 | 18 | 5 |
| W002.AC022 | Square | 22 x 22 | M10 | 18 | 5 |
| W002.AC025 | Square | 25 x 25 | M10 | 19 | 5 |
| W002.AC030 | Square | 30 x 30 | M10 | 20 | 6 |
| W002.AC035 | Square | 35 x 35 | M10 | 21 | 6 |
| W002.AC040 | Square | 40 x 40 | M10 | 22 | 6 |
| W002.AC050 | Square | 50 x 50 | M10 | 30 | 6 |
| W002.AC130 | Rectangular | 20 x 30 | M10 | 19 | 6 |
| W002.AC135 | Rectangular | 20 x 35 | M10 | 19 | 6 |
| W002.AC140 | Rectangular | 20 x 40 | M10 | 19 | 6 |
| W002.AC150 | Rectangular | 20 x 50 | M10 | 19 | 6 |
| W002.AC160 | Rectangular | 20 x 60 | M10 | 19 | 6 |
| W002.AC170 | Rectangular | 25 x 50 | M10 | 22 | 6 |
| W002.AC218 | Round | Ø 18 | M10 | 18 | 6 |
| W002.AC220 | Round | Ø 20 | M10 | 18 | 6 |
| W002.AC222 | Round | Ø 22 | M10 | 19 | 6 |
| W002.AC225 | Round | Ø 25 | M10 | 19 | 6 |
| W002.AC228 | Round | Ø 28 | M10 | 19 | 6 |
| W002.AC230 | Round | Ø 30 | M10 | 19 | 6 |
| W002.AC232 | Round | Ø 32 | M10 | 19 | 6 |
| W002.AC235 | Round | Ø 35 | M10 | 20 | 6 |
| W002.AC240 | Round | Ø 40 | M10 | 21 | 6 |
| W002.AC250 | Round | Ø 50 | M10 | 21 | 6 |

