

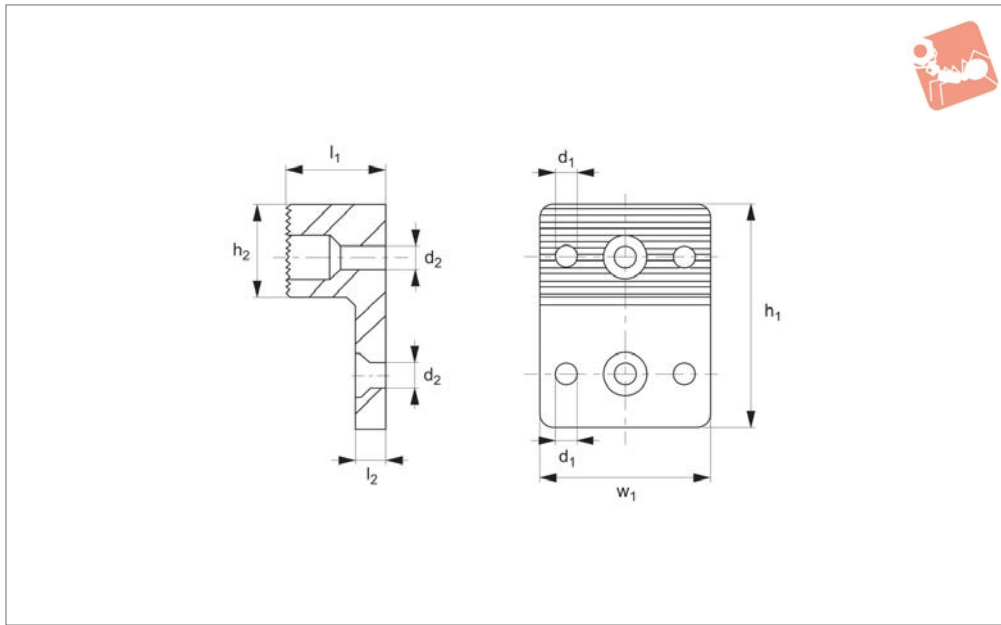

# Clamping Jaw for clamps 12320

# Heavy-Duty Side Clamping



## 12330

HEAVY-DUTY SIDE CLAMPING

### Material

Steel, case hardened, with M8 bolts.

machining of rough parts. Can be mounted on the clamping jaw or the stop.

### Tips

Clamping jaw with serrated surface for

Order No.	For clamp $w_1$	$d_1$	$d_2$	$h_1$	$h_2$	$l_1$	$l_2$	Weight g
12330.W0019	65	8.1	9	85	35	38	12	889
12330.W0026	75	8.1	9	100	45	38	12	1306
12330.W0038	90	8.1	9	120	50	38	12	1829

