



One-Touch Fastener - Ball Clamping

locating bush and receiver - mechanical release



One Touch Fasteners

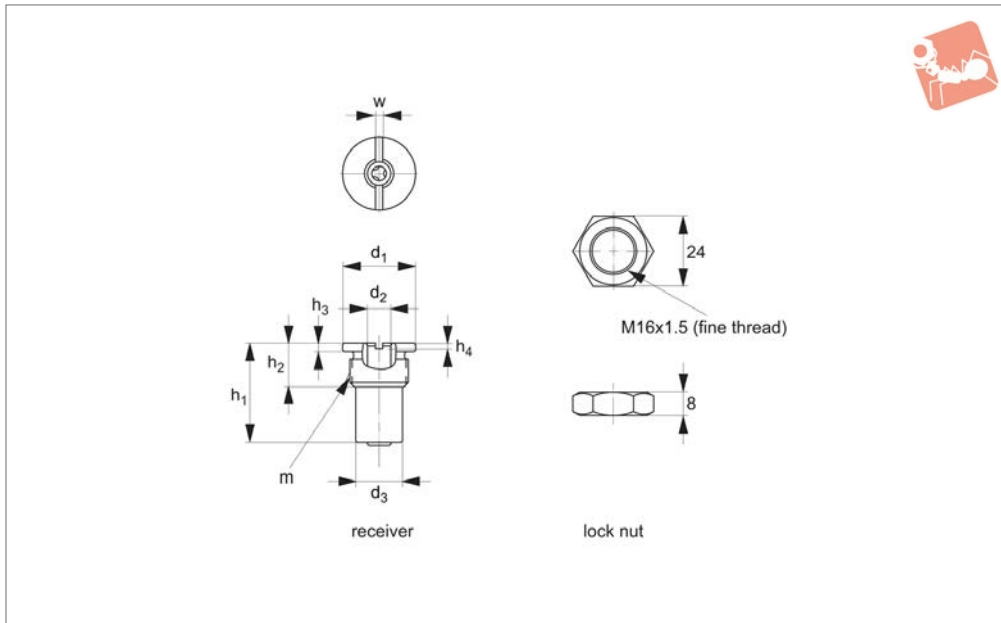

33936

ONE TOUCH FASTENERS

Material

Body: steel, nickel plated.
Balls & spring: stainless steel.

Technical Notes

One-touch fasteners are the ideal solution for applications requiring rapid and recurring change over of tooling or set ups. Use in applications as diverse as bottling processes, machine covers, changing of cogs and drive belts. One-touch fasteners provide a quick, simple and secure change

over solution - no time waste in unfastening screws or other permanent fixings, and no opportunity for lost fixings in your machinery. Temperature resistant to 180°C.

Important Notes

Suitable for panels/enclosures of 6 to 32 mm thickness. Used inconjunction with pin 33930. Mechanical release only (no safety release).

* Tensile strength stated is for locked posi-

tion/state of the fastener.

Actuation:

Engage pin into receiver, a positive „click“ is heard, securing balls are engaged. Panels are securely fastened. To release, simply pull panels apart with sufficient force to overcome securing balls, panel is released.

Order No.	Type	d ₁ tol. h9	d ₂ +0.10 +0.05	d ₃	h ₁	h ₂	h ₃	m	w	Clamping force N	Shear strength N	Tensile strength N	Weight g
33936.W0807	Receiver	Ø20	Ø8	Ø14	29	15	3	M16x1,5	2,5	7	1800	1800	30
33936.W0815	Receiver	Ø20	Ø8	Ø14	29	15	3	M16x1,5	2,5	15	1800	1800	30

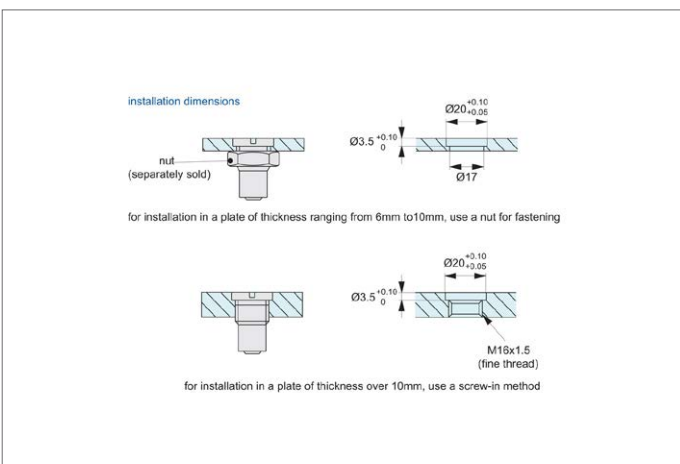



One-Touch Fasteners - Alternatives to Screws

ONE TOUCH FASTENERS

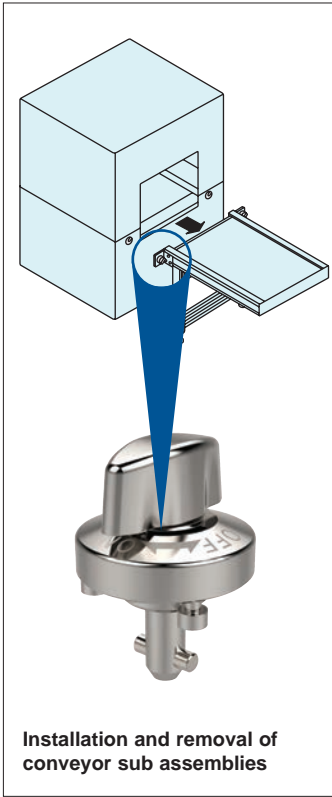

Installation and removal of conveyor sub assemblies

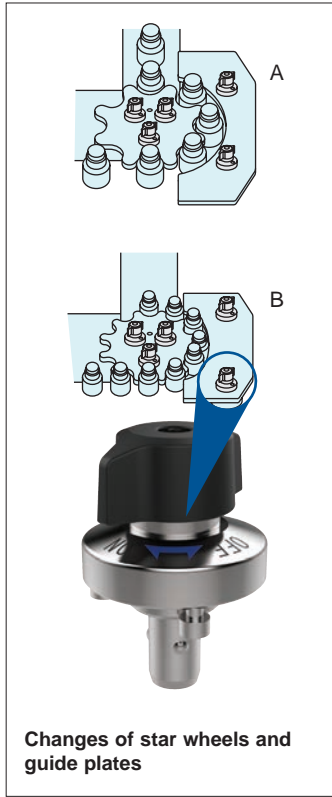

Changes of star wheels and guide plates

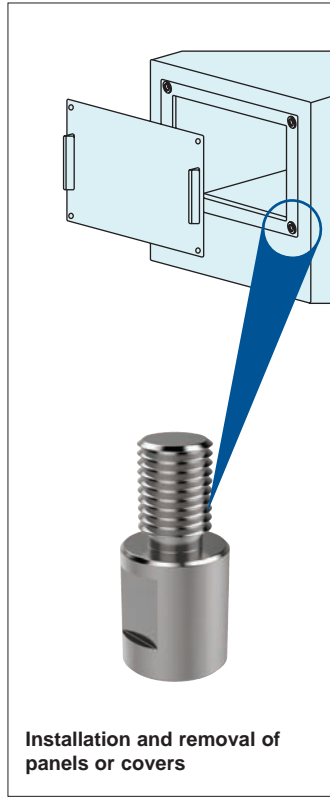

Installation and removal of panels or covers

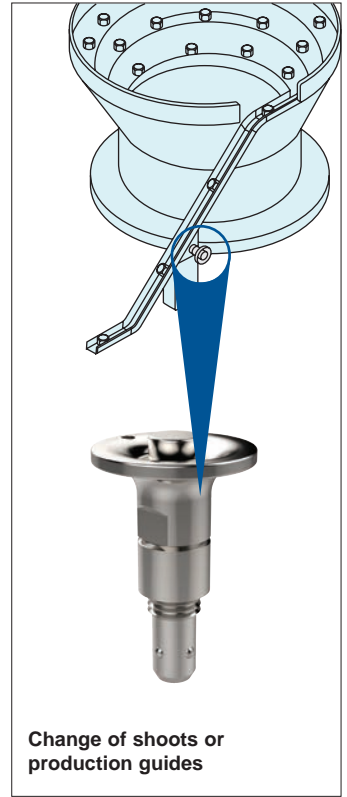

Change of shoots or production guides

Easy & Secure! For Quick Changeover with No Tools!





One-Touch Change Over

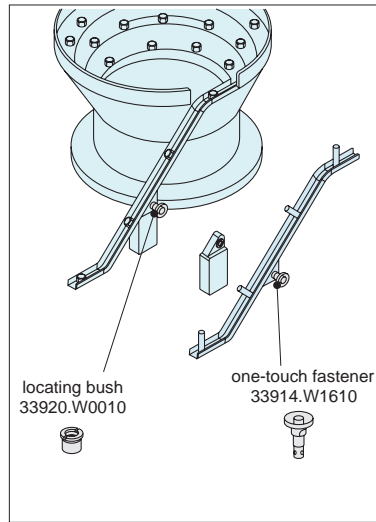
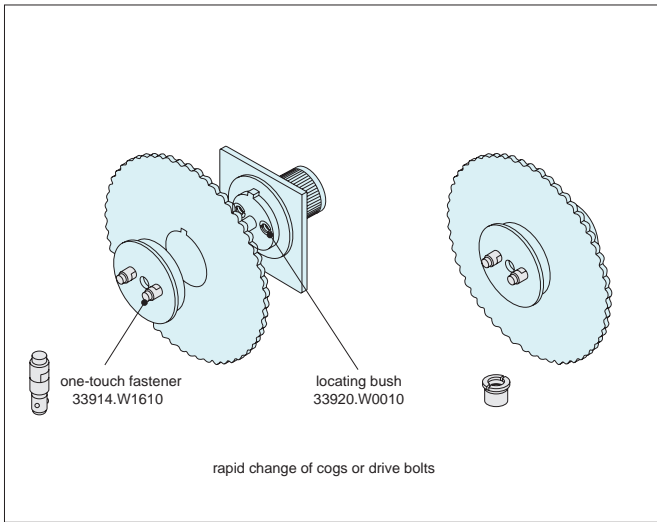

Installation and Removal of Rotary Blades and Changes of Shooters

ONE TOUCH FASTENERS

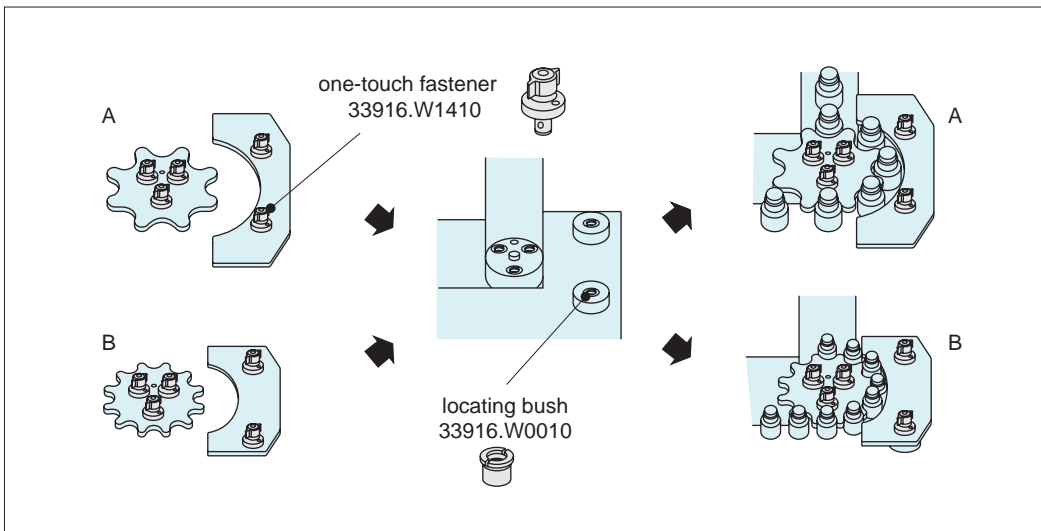

Changes of Star Wheels and Guide Plates

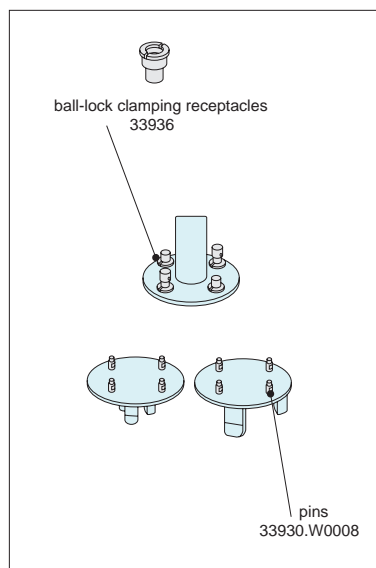
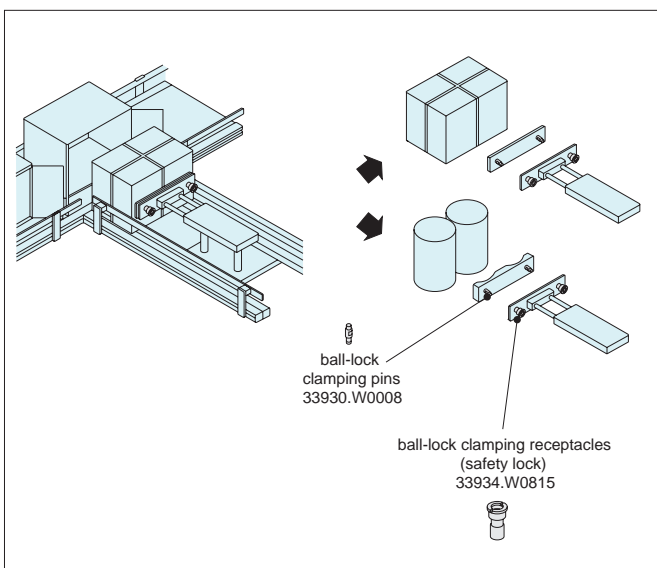

Changes of Pusher and Changes of Chuck Handling Machines

ov-W33910-A-T-W33956-A-T-one-touch-fasteners-b-rmh - Updated - 27-10-2022