

17400

SUPPORTS & STOPS

Material

Steel, ground and hardened.

For machine T-slots from 12mm to 22mm.

Position stop in machine slot, actuate the eccentric cam to lock in place.

Technical Notes

Compact, strong and easily removable.

Order No.	w_2	h_1	h_2	l_1	Slot size w_1
17400.W0020	6.0	33	17	25	12
17400.W0025	6.0	36	20	30	14
17400.W0030	8.0	40	20	30	16
17400.W0035	9.8	40	21	40	18
17400.W0045	12.0	55	27	50	22

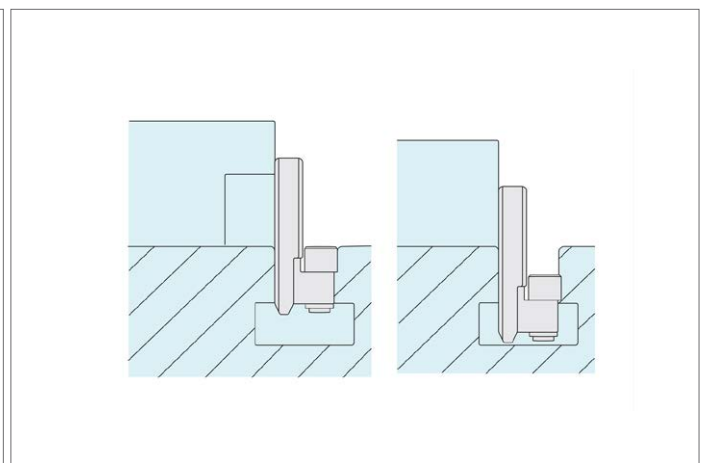



17403

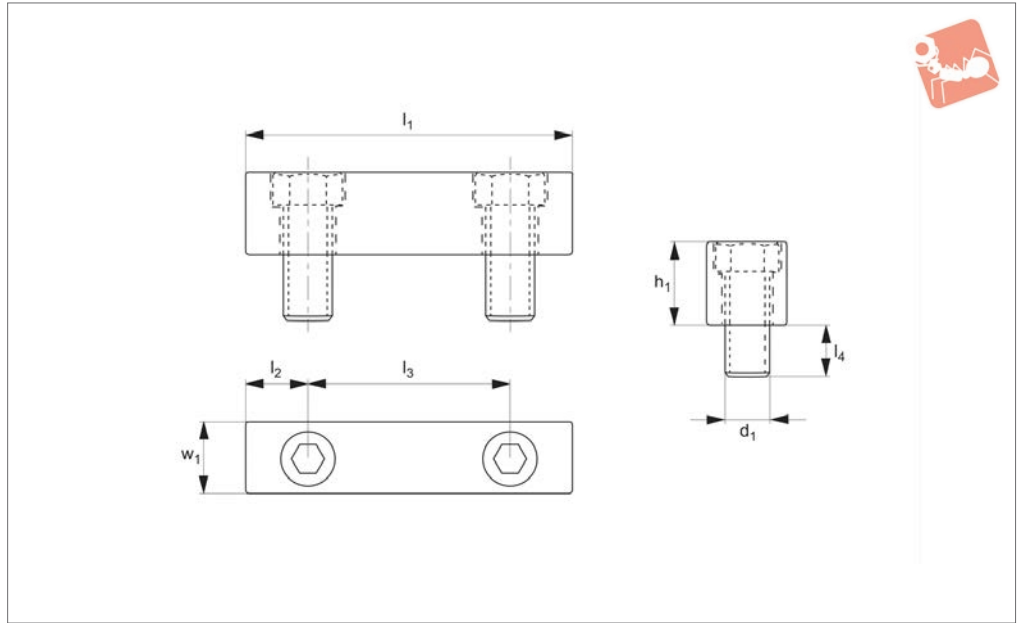

Material

Low carbon steel, precision ground square. Mounting screws included.

Technical Notes

The locating rails can be machined and are ideal for using with our machinable

clamps.

Important Notes

1. Mill a slot to locate the rail. Depth of slot will determine rail height.
2. Drill and tap the required holes.
3. For better rigidity the rail should be

pinned to the fixture plate with dowel pins.
4. If rails are to be machined to hold round pieces, the clamps should be mounted and both rail and clamps machined at the same time.

Order No.	w_1 +0.00 -0.01	d_1	h_1	l_1	l_2	l_3	l_4	No. of holes	Weight g
17403.W0200	15	M 6	12	50	15	20	11	2	68.0
17403.W0210	15	M 6	12	100	20	30	11	3	140.6
17403.W0220	15	M 6	12	150	30	30	11	4	208.7
17403.W0240	15	M 6	12	250	25	50	11	5	353.8
17403.W0260	24	M10	18	75	20	35	18	2	258.5
17403.W0280	24	M10	18	150	30	30	18	4	512.6
17403.W0300	24	M10	18	250	25	50	18	5	848.2

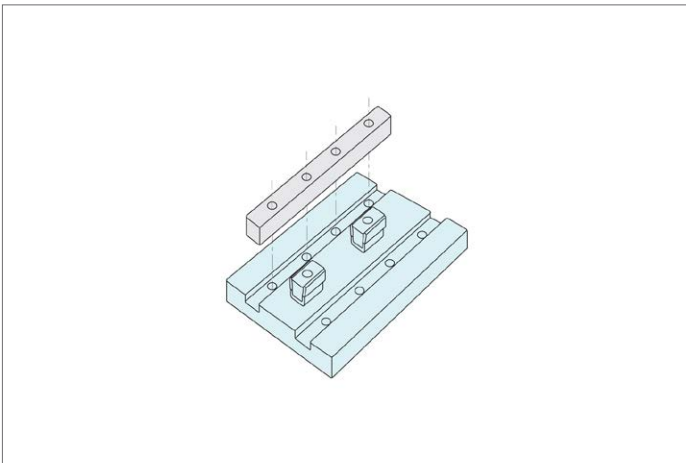

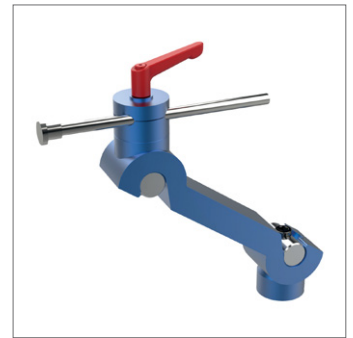
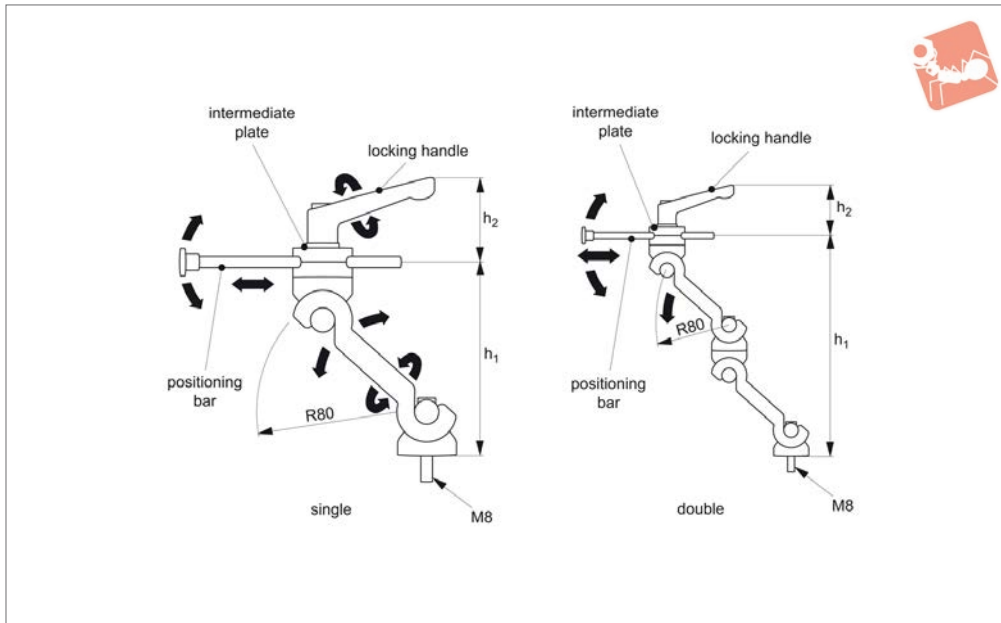

17405

SUPPORTS & STOPS

Technical Notes

Three dimensional, fully adjustable end stops for milling machines, and vices.

Can also be used as a support to minimise work-piece vibration.

Order No.	Bar dia.	Height adj. min. max.	h_1	h_2	Type
17405.W0420	6x150	0-150	145	60	Single
17405.W0430	6x150	0-300	300	60	Double
17405.W0710	-	-	-	-	Intermediate Plate
17405.W0720	-	-	-	-	Locking Handle

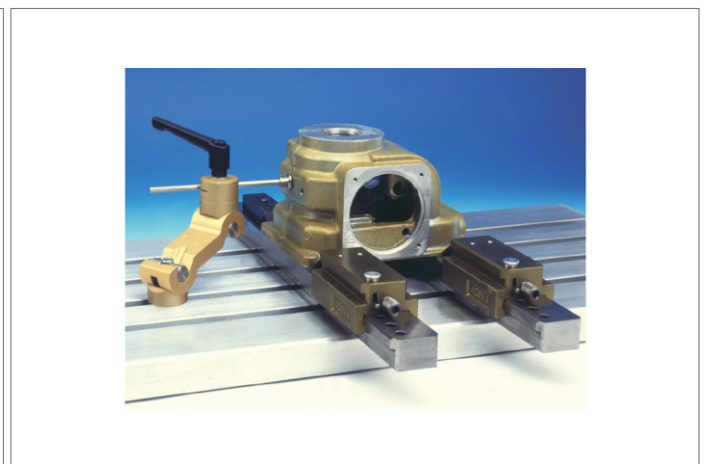
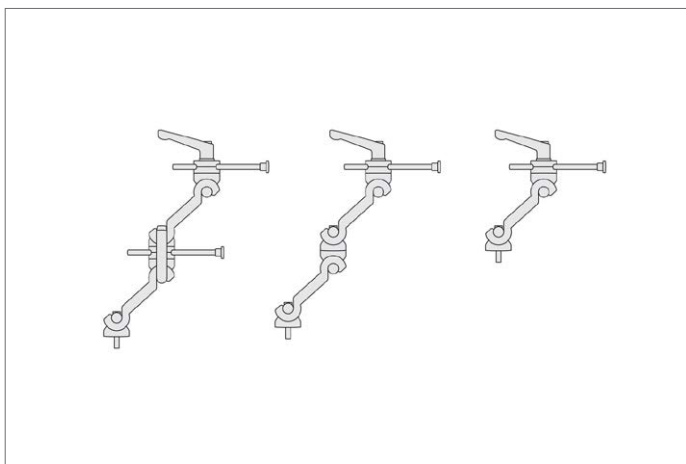



17420

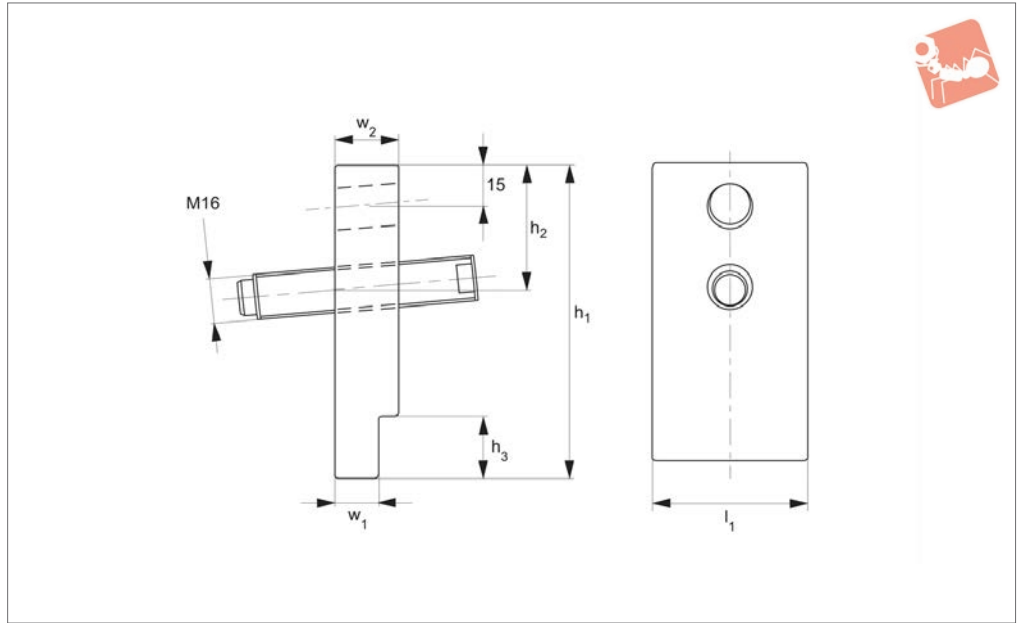

Material

Steel, tempered, with two threaded holes M16, and adjustable set screw M16x80.

on slotted tables. The side stop slips into the T-slot and locks when the adjusting bolt comes into contact with the workpiece.

Technical Notes

Used to position long or heavy workpieces

Order No.	w_2	h_1	h_2	h_3	l_1	Slot w_1	Weight g
17420.W0018	20	100	40	20	50	18	805
17420.W0020	25	125	40	30	80	20	1880
17420.W0022	25	125	40	30	80	22	1920
17420.W0024	32	150	65	40	100	24	3515
17420.W0028	32	150	65	40	100	28	3645
17420.W0036	40	160	65	50	120	36	4870

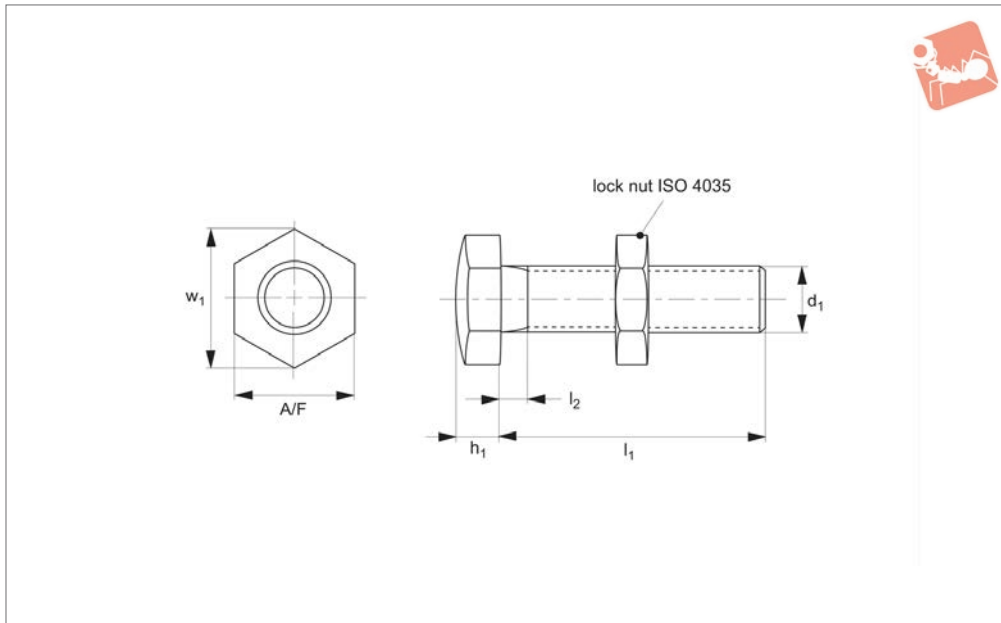

18300

SUPPORTS & STOPS

Material

Bolt: steel, blackened and with a hardened head. Tensile strength 500N/mm².

and rounded head which can be used as support or setting bolt as an end stop. These bolts are normally used together with a locknut.

Technical Notes

Setting bolts are produced with a hardened

Order No.	d ₁	l ₁	l ₂	h ₁	w ₁	A/F
18300.W0031	M 3	10	2	2.0	6.4	5.5
18300.W0032	M 3	20	2	2.0	6.4	5.5
18300.W0033	M 3	30	2	2.0	6.4	5.5
18300.W0041	M 4	10	2	2.8	8.1	7.0
18300.W0042	M 4	20	2	2.8	8.1	7.0
18300.W0043	M 4	30	2	2.8	8.1	7.0
18300.W0051	M 5	20	2	3.5	9.2	8.0
18300.W0052	M 5	30	2	3.5	9.2	8.0
18300.W0053	M 5	40	2	3.5	9.2	8.0
18300.W0061	M 6	30	3	4.0	11.5	10.0
18300.W0062	M 6	40	3	4.0	11.5	10.0
18300.W0063	M 6	50	3	4.0	11.5	10.0
18300.W0081	M 8	30	4	5.5	15.0	13.0
18300.W0082	M 8	40	4	5.5	15.0	13.0
18300.W0083	M 8	50	4	5.5	15.0	13.0
18300.W0101	M10	40	5	7.0	19.6	17.0
18300.W0102	M10	50	5	7.0	19.6	17.0
18300.W0103	M10	60	5	7.0	19.6	17.0
18300.W0104	M10	70	5	7.0	19.6	17.0
18300.W0121	M12	40	5	8.0	21.9	19.0
18300.W0122	M12	50	5	8.0	21.9	19.0
18300.W0123	M12	60	5	8.0	21.9	19.0
18300.W0124	M12	70	5	8.0	21.9	19.0
18300.W0161	M16	50	6	10.0	27.7	24.0
18300.W0162	M16	60	6	10.0	27.7	24.0
18300.W0163	M16	70	6	10.0	27.7	24.0
18300.W0164	M16	80	6	10.0	27.7	24.0

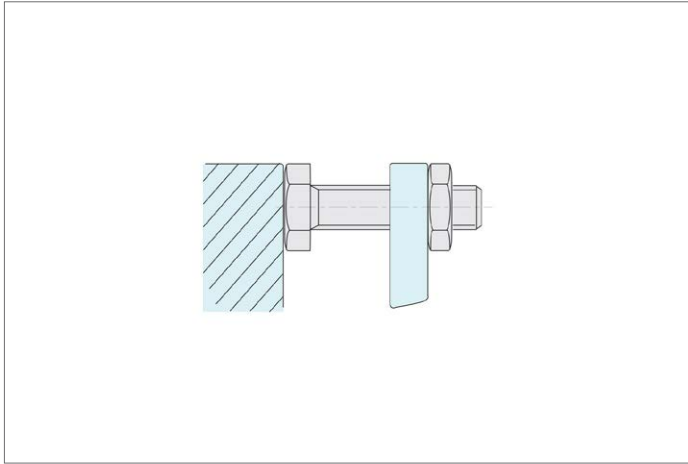

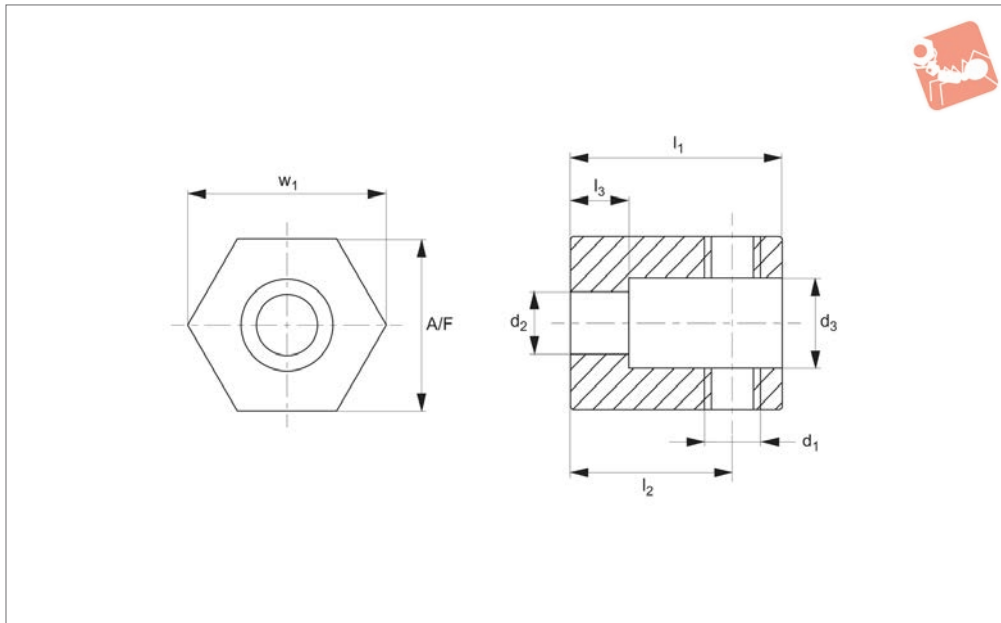

30400

SUPPORTS & STOPS

Material

Steel, heat-treated, blackened.

34500 and thrust pads no. 34520 - used as adjustable stops.

Technical Notes

Used in conjunction with grub screws no.

Order No.	w ₁	d ₁	d ₂	d ₃	l ₁	l ₂	l ₃	A/F	Weight g
30400.W0045	25.4	M 8	8.4	14	26	20	8	22	55
30400.W0145	40.0	M12	13.0	19	44	34	12	36	280

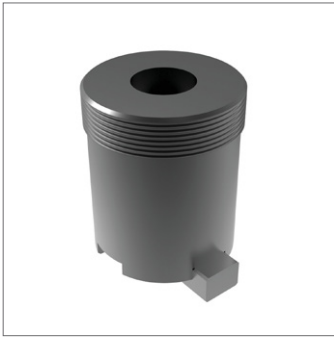

30420

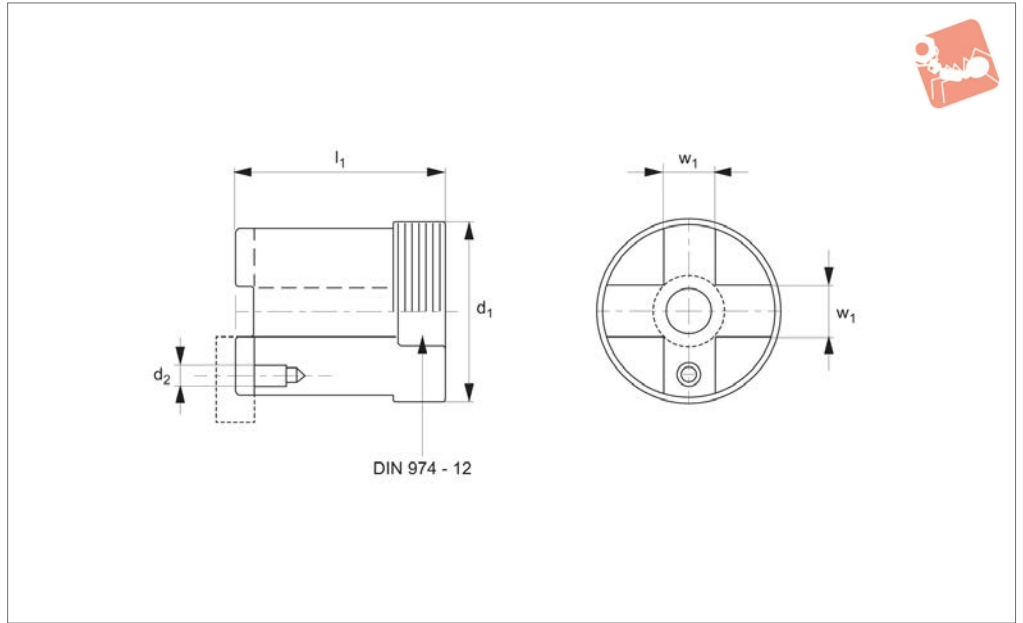

SUPPORTS & STOPS

Material

Steel, case-hardened and ground.

Order No.	w_1 tol. H7	d_1 ± 0.01	d_2	l_1	Weight g
30420.W0050	14	50	M 6	60	750